

STROJ DARK MAGIC THRUSTING BED EXCELLENT POWER



Návod

OVLÁDANIE

- 1) Spodná časť vibrátorov slúži ako kryt na batérie.
- 2) Ak chcete vibrátor zapnúť, odstráňte kryt batérií, vložte batérie AA podľa vyznačených pólov.
- 3) Vibrácie sa ovládajú otočným kolieskom, ktoré slúži ako kryt batérií.
- 4) Na použitie s ležadlom je potrebné namontovať redukciu.

Grafický návod na montáž nájdete na nasledujúcich stranách návodu.

ÚDRŽBA

Po každom použití vibrátor opláchnite vlažnou vodou s mydlovým prostriedkom. Môžete tiež použiť **čistič erotických pomôcok**, ktorý navyše pomáha na odstránenie mikroskopických nečistôt. Výrobok stačí nastriekať, nechať cca 1 minútu pôsobiť a potom osušiť uterákom alebo utierkou, ktoré nepúšťa vlákna.

VODEODOLNOSŤ

Vibrátor **nie je vodotesný ani vodeodolný!**

LUBRIKÁCIA

Vzhľadom na materiál vibrátora môžete použiť **lubrikačné prostriedky** na akejkolvek báze.

POHON A NABÍJANIE

Vibrátory sú napájané batériami AA. Odporúčame používať alkalické batérie pre väčšiu výdrž alebo dobíjacie batérie.

Ovládač je napájaný 12 V batériou 23A.

Samotný prístroj je napájaný ôsmimi batériami LR 14.

SKLADOVANIE

Skladujte oddelene od ostatných erotických pomôcok na suchom a tmavom mieste.

OBSAH BALENIA

3x vibrátor, lôžko, pedálová pumpa, diaľkové ovládanie, redukcia na upínanie vibrátorov, batérie.

INSTALLATION FOR THE VIBRATOR ON THE VIBRATING COMPONENT

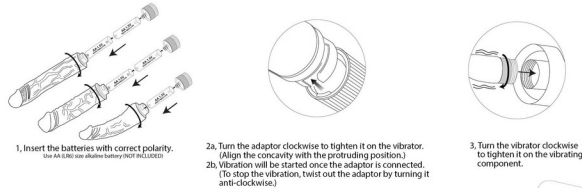

BATTERY INSTALLATION FOR WIRELESS REMOTE CONTROLLER

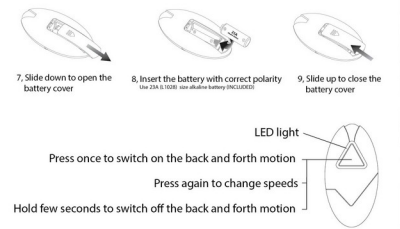

NOTES

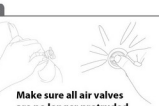

BATTERY INSTALLATION FOR VIBRATORS

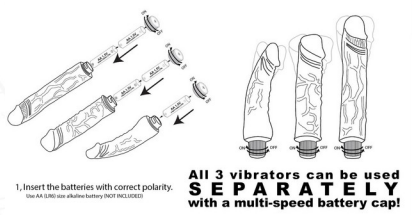

Warnings:

1. Be sure to insert the batteries correctly and always follow the manufacturer's product and battery instructions.
2. Do not mix alkaline, standard (carbon-zinc) or rechargeable (nickel-cadmium) batteries.
3. Always remove weak or dead batteries from the product.
4. Operating Temperature 0°C-40°C
5. The device is not to be used as a flotation device.
6. Only use the pump provided in the box to inflate the bed.
7. This product is not waterproof, it can not be used in water.
8. The max. weight : 300 lbs.
9. If apply the exceed force or over 300 lbs, may cause the bed flip over.
10. Always turn power off after usage.
11. The batteries should be removed after use.

Frequency and maximum transmitting power : 433.94MHz 3dBm
Receiver category 3

Hereby, Excellent Power Industrial Ltd. declares that this radio control product is in compliance with the essential requirements and other relevant provisions of Directive 1999/5/EC. The declaration of conformity may be consulted at www.epi-pow.com

INFLATABLE BED INSTRUCTIONS

MODEL NO. : FVRJ001A00-010

WHAT'S IN THE BOX?

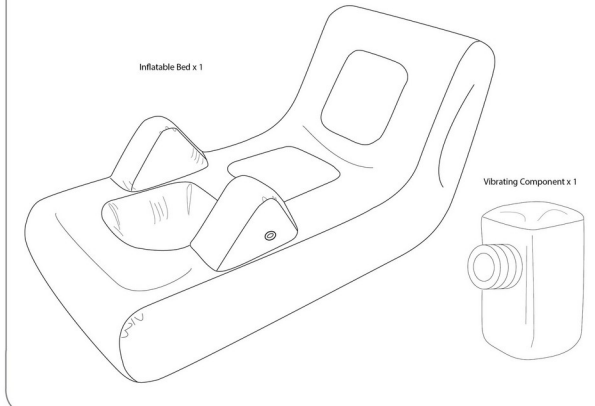
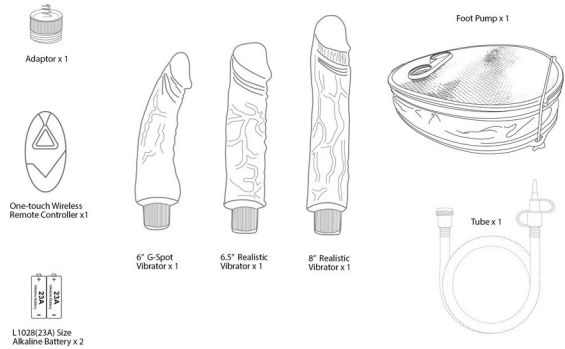

INFLATABLE BED INSTRUCTIONS

MODEL NO. : FVRJ001A00-010

WHAT'S IN THE BOX?

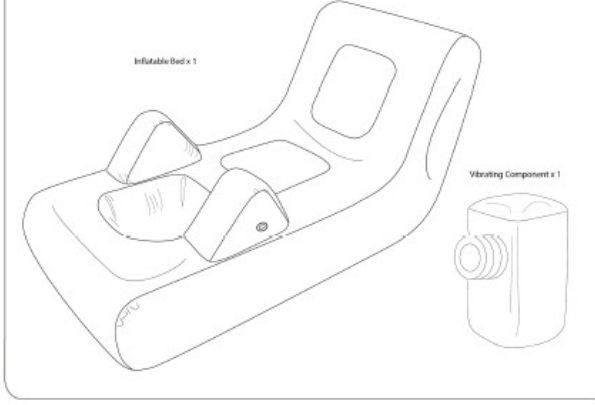
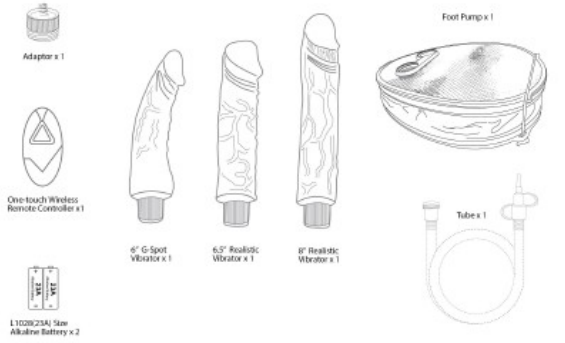

INSTALLATION FOR THE VIBRATOR ON THE VIBRATING COMPONENT

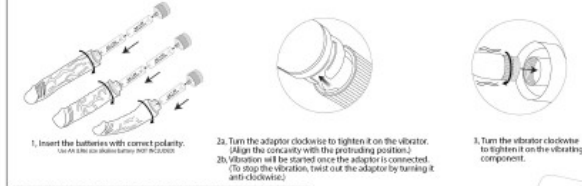

BATTERY INSTALLATION FOR WIRELESS REMOTE CONTROLLER

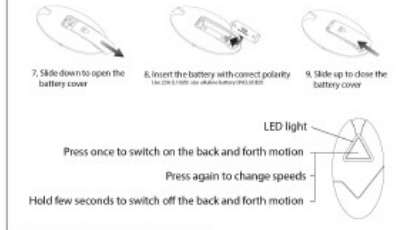

NOTES



BATTERY INSTALLATION FOR VIBRATORS

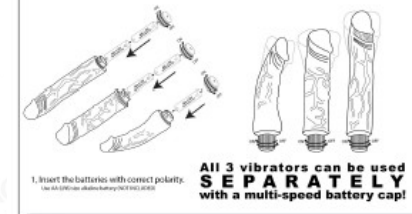

Warnings:

1. Be sure to insert the batteries correctly and always follow the manufacturer's product and battery instructions.
2. Do not mix alkaline, standard (carbon-zinc) or rechargeable (nickel-cadmium) batteries.
3. Always remove weak or dead batteries from the product.
4. Operating Temperature 0°C-40°C
5. The device is not to be used as a flotation device.
6. Only use the pump provided in the box to inflate the bed.
7. This product is not waterproof, it can not be used in water.
8. The max. weight : 300 lbs.
9. If apply the exceed force or over 300 lbs, may cause the bed flip over.
10. Always turn power off after usage.
11. The batteries should be removed after use.

Frequency and maximum transmitting power : 433.94MHz 3dBm
Receiver category 3

Hereby, Excellent Power Industrial Ltd. declares that this radio control product is in compliance with the essential requirements and other relevant provisions of Directive 1999/5/EC. The declaration of conformity may be consulted at www.epi-pow.com

Trinet Corp., s.r.o.

Provozní 5560/1b
722 00 Ostrava – Třebovice, Czech Republic

Potrebujete poradit?

Napište nám na flagranti@flagranti.sk
alebo zavolajte na tel.: +421 918 345 016

• How to use •

Insert batteries twist vibrator into the adaptor.



ADAPTOR

Comes with 1 adaptor designed to match all vibrators.

Vibration will start once the adaptor is engaged. To stop vibration, twist out the vibrator.



Screw vibrator with adaptor into the cup connector until tightened.



Battery Box
Use 8 x C (LR14) size alkaline batteries. (Not Included)



PRESS TO OPEN



Tear off the velcro cover for battery installation. The battery box is located at the bottom of bed component. Always remove batteries after usage.

Turn the main power on before using remote control. Always turn power off after usage.



ON OFF



Insert bed component into the lounge.



Remote Control
Use 1 x L1028 (23A) size alkaline battery. (2 Batteries Included)



SLIDE TO OPEN



Hold the button to switch on the vibrator. Press again to change pattern. Hold the button to switch off the vibrator. (3 speeds vibrator)

5 Main Valves



POWERFUL VIBRATION



Foot Pump (Included)





Profound stroking action gives ultimate thrusting pleasure.



Ergonomic design for sex position.



Trinet Corp., s.r.o.

Provozní 5560/1b
722 00 Ostrava – Třebovice, Czech Republic

Potrebujete poradit?

Napište nám na flagranti@flagranti.sk
alebo zavolajte na tel.: +421 918 345 016